

1 Block the running escalator opposite to the side you are cleaning.



2 Mix solution 10 parts water, to 1 part Clean-TEQ.



3 Pour the diluted solution into the trough. Do not overfill!

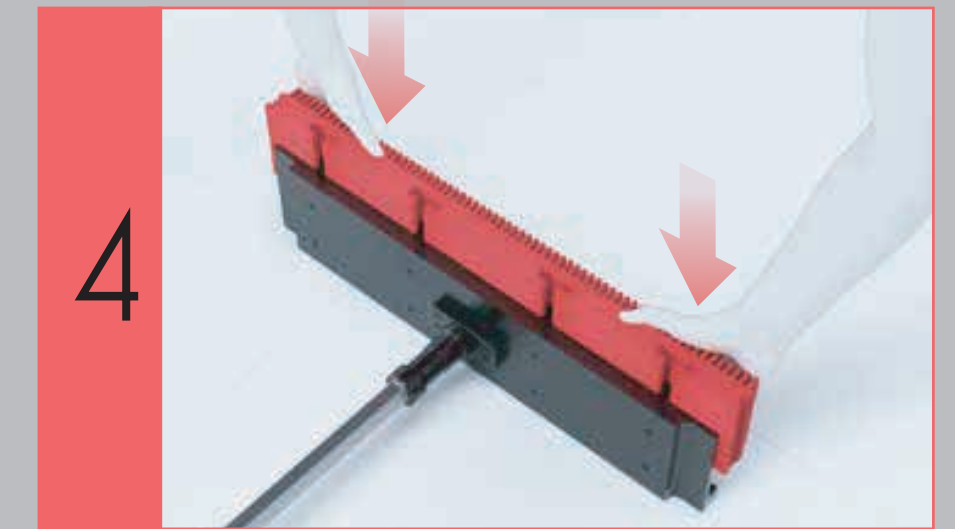

4 Mount pad to device.

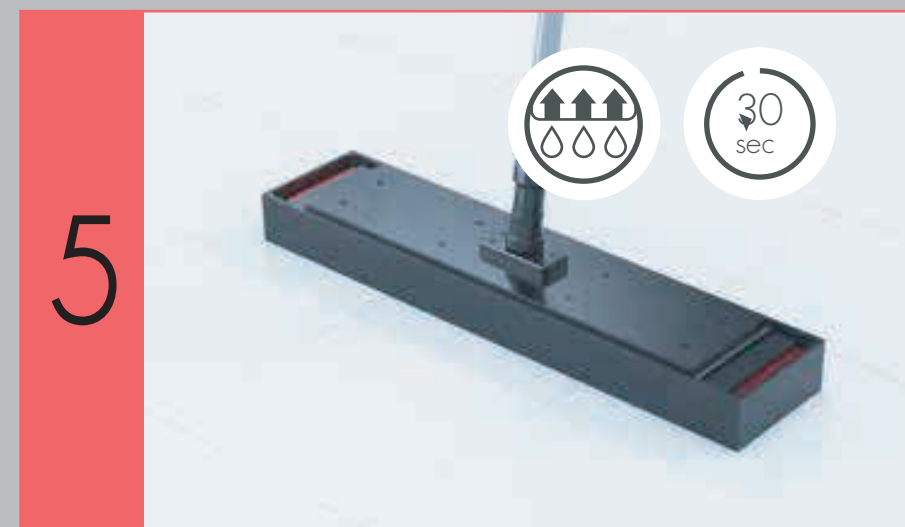

5 Allow the cleaning pad to absorb the solution.

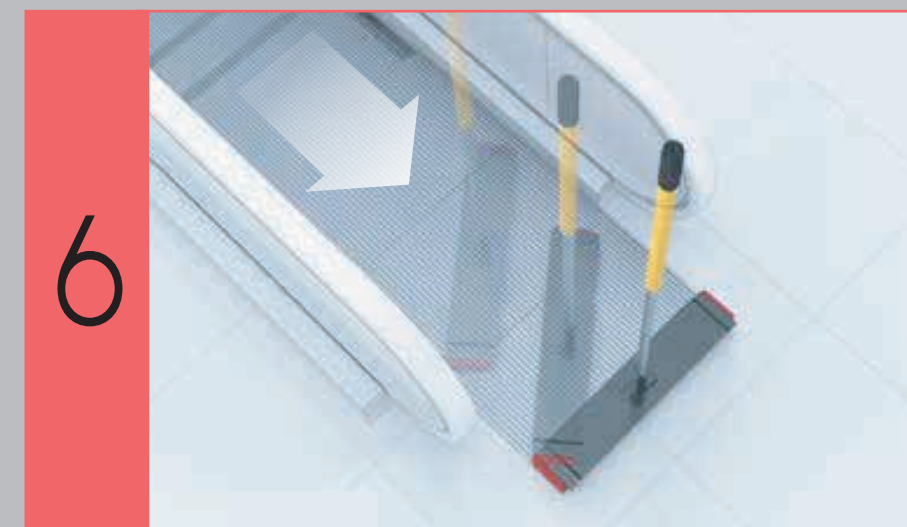

6 Place the device onto the moving treads, allow it to align with the combs and drop into place.

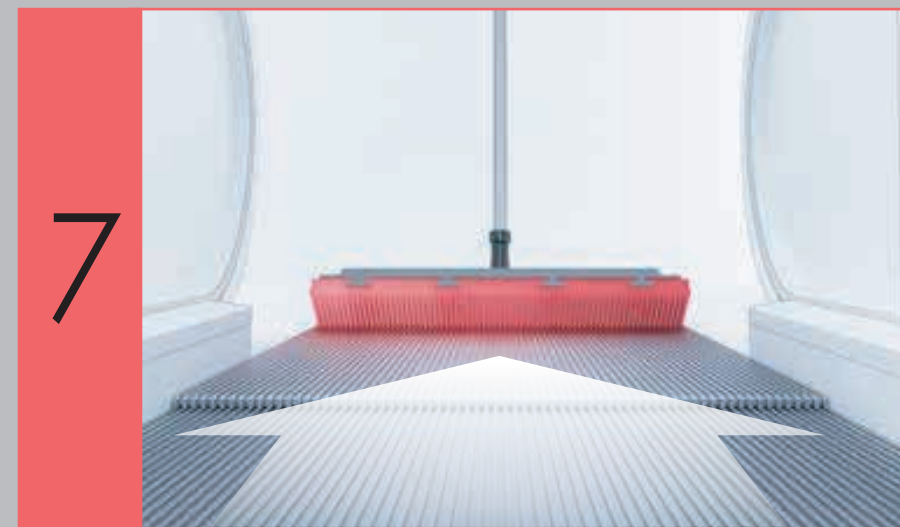

7 Tilt the device back and then forward, to help it align with the tread groves.



8 Hold the device in place with light downward pressure.



9 Remove the dirty pad carefully.

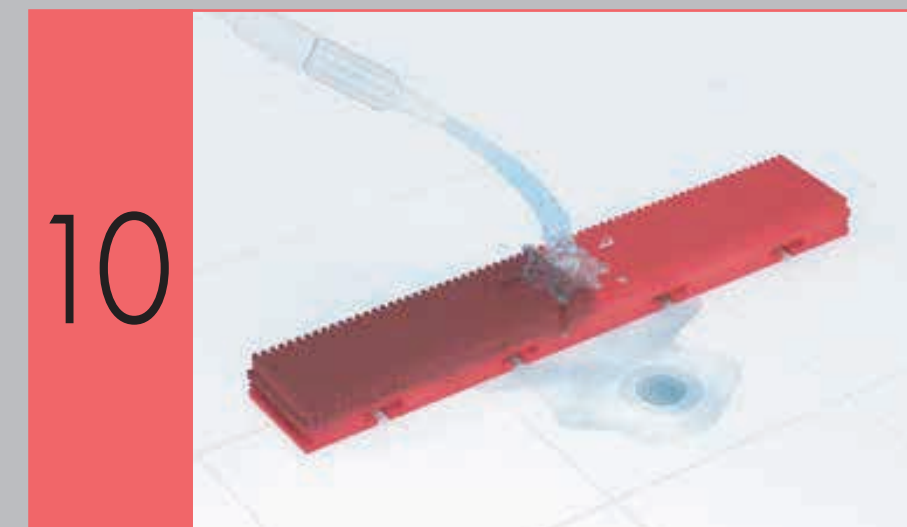

10 Rinse pads using moderate water pressure.

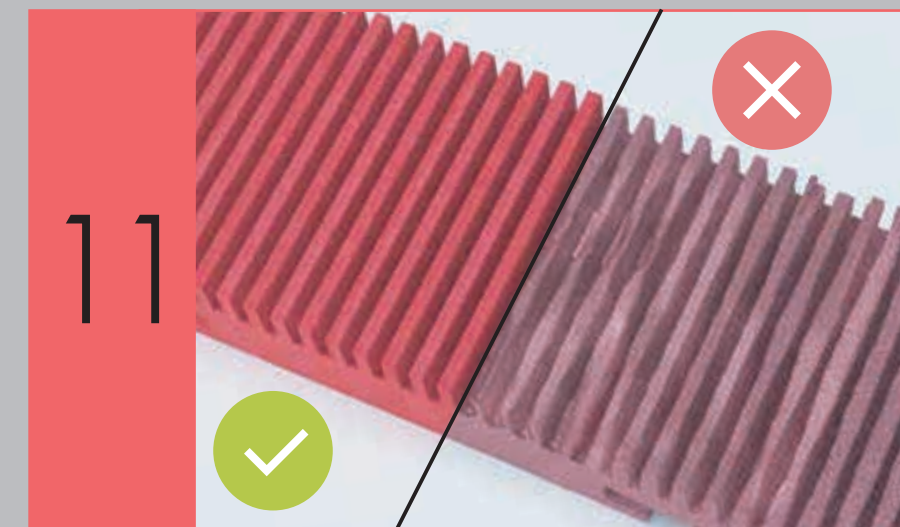

11 Replace pads when they become damaged or worn.



12 Dry & re-use pads.

## ESCALATOR CLEANING FREQUENCY

Traffic	Location	Recommendation
HIGH	Airports & Subways	Daily
MEDIUM	Shopping Malls & Casinos	Bi-Weekly (twice a week)
LOW	Hotels & Office Buildings	Weekly



Important: Keep fingers, loose clothing, shoe laces, hair, jewelry etc. away from the device and the escalator treads during use. Do not stand or step on the device while it is in operation. The escalator must be dry before allowing passengers back on.