

SC 60L Breakdown Figure

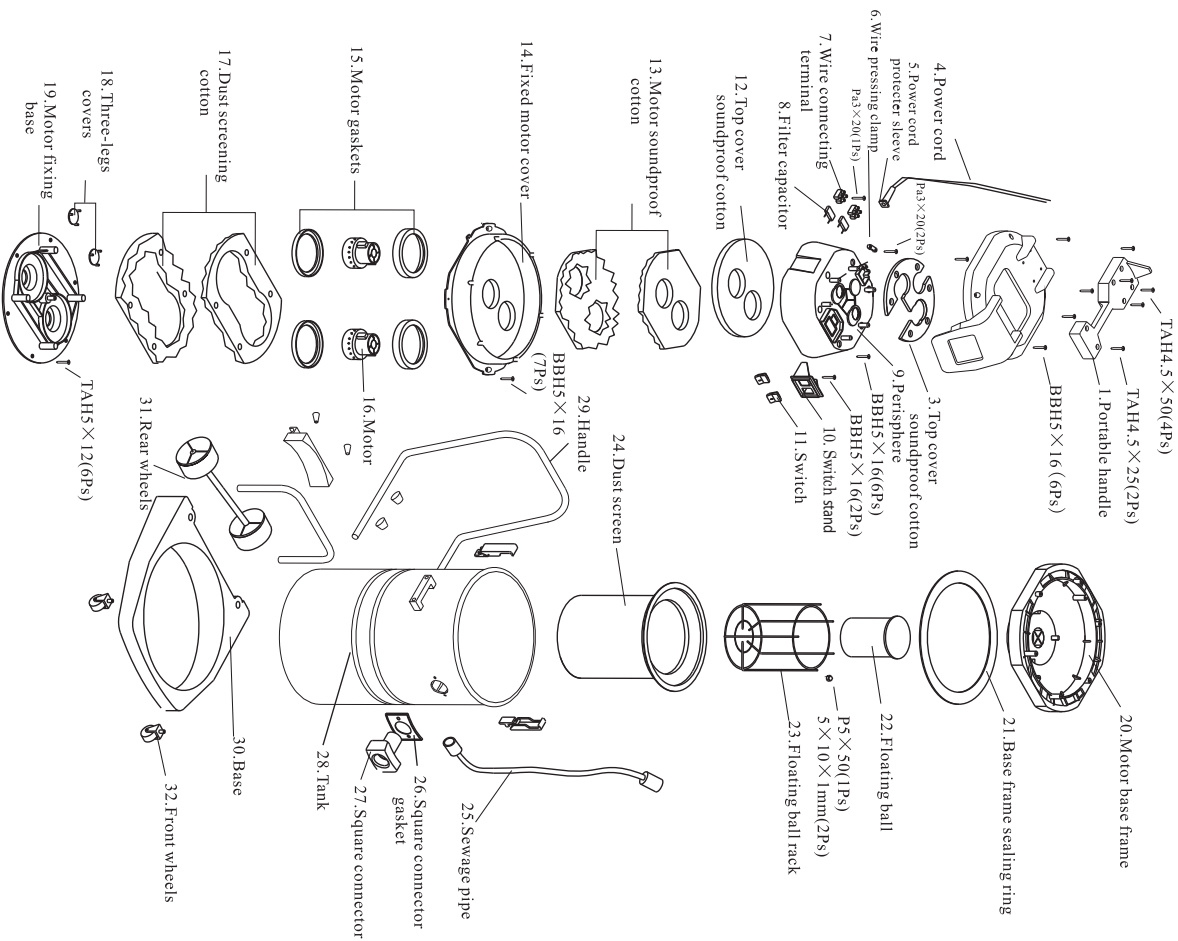

SC60L Dust and Water Vacuum Cleaner

Features:

With a strong responding motor, this machine has a very ideal effect in dust and water vacuuming. The product is suitable for a variety of uses, e.g. large scale workshops, factory premises, malls, hotels, office buildings and other large scale public places.

Main unit:



SC-602S stainless steel tank

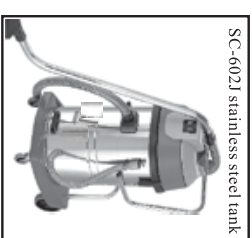

SC-602J stainless steel tank



SC-603J plastic tank

Technological parameters:

Model	SC-602S/SC-602J/SC-603J	Vacuum suction	250 bar
Capacity	60 L	Cooling mode	Circulating
Working voltage	220-240V	Tank diameter	440 mm
Power	2000W, single-phase	Height	970 mm
Function	Dust and water vacuuming	Matching part	Φ40
Air flow rate	106 L/s	Power cord	8 m

Standard attachment:

